



Welcome to the 2019 ASCLS-Idaho Annual Convention

I am very excited about this year's meeting. The planning committee has done a wonderful job of providing an exciting and varied program of outstanding speakers and presentations. This is your opportunity to come together with your fellow laboratory professionals, to renew old friendships, form new ones, and to interact with this year's group of students as they make the transition in to the workforce.

The combination of old friends, new friends, an exhibitor hall full of the latest in laboratory technology, and hours and hours of continuing education with fabulous speakers on the hottest topics in clinical laboratory science, you are sure to have a bit of fun, and come away from the convention enriched and energized, and ready to tackle the challenges of tomorrow in the laboratory. Welcome to ASCLS-Idaho Convention 2019!

Chris Doran, ASCLS-Idaho President 2018-2019

ASCLS - IDAHO PRESENTS:

“Cheers to 70 Years”

APRIL 11 – 13, 2019

RED LION HOTEL
BOISE DOWNTOWNER
1800 W. FAIRVIEW AVENUE
BOISE, IDAHO 83702
(208) 344-7691

Spring Convention Committee Members

General Chair.....	Melissa Dumoulin
Program Chair.....	Chris Doran
Sponsorship Chair.....	Mary Cobos
Social Chair.....	Mary Echanove Brown
Vendor Chair.....	Debbie Shell
Publicity Chair.....	Doug Powell
Registration Chair.....	Debbie Cutforth
Financial Chair.....	Susan Morris
P.A.C.E.....	Marj Montanus
Scientific Assembly.....	Doug Powell

ASCLS-Idaho Board of Directors - 2019

President.....	Chris Doran
President-Elect.....	Kami MCGann
Past President.....	Mechelle Reeve
Secretary.....	Mary Echanove Brown
Treasurer.....	Amy Huse
Editor.....	Jessica Lewis
Administrative Secretary.....	Debbie Shell
First Year Board Member.....	Kathryn Norton
Second Year Board Member.....	Marj Montanus

Special Notes

PACE® Validation: ASCLS-Idaho is approved as a provider of continuing education programs. All general sessions and workshops are PACE® approved. Continuing Education credits are now documented electronically by the participant through the ASCLS website using the CE Organizer program at the conclusion of the conference. All attendees will receive a P.A.C.E Documentation Form with instructions when they register at the conference. This form will list all sessions and workshops with the P.A.C.E. number and a space to note the applicable session or workshop number. The session number is a unique number assigned to that session or workshop and will be announced at the end of each session. Attendees will need to write that number down on their P.A.C.E. Documentation Form. Within 30 days after the conclusion of the conference, attendees must log on to the CE Organizer at the ASCLS website to enter their documentation and print their P.A.C.E certificate. After 30 days, attendees will be unable to enter documentation for this conference or print a P.A.C.E certificate. Attendance rosters and P.A.C.E stickers will not be used at this conference. Retain the completed P.A.C.E Documentation Form along with the P.A.C.E. certificate for your permanent record.

ADA Statement: ASCLS-Idaho is committed to inclusion and universal access to all of its programs. We will make every effort to provide reasonable accommodations to individuals with disabilities. If you have a disability that requires special accommodations, please contact Melissa Dumoulin at (208) 859-0559 by March 29th, 2019.

ASCLS Membership

Becoming an ASCLS-Idaho Member: ASCLS-Idaho is the Idaho branch of the American Society for Clinical Laboratory Science. When you join, you become a member of both organizations. Your membership demonstrates your commitment to supporting and advancing your chosen profession. ASCLS and ASCLS-Idaho provide you with connections to other clinical laboratory professionals that can prove invaluable in your career. In addition, ASCLS maintains a professional lobbyist in Washington D.C. who monitors legislations that may affect our profession and actively works to represent our views and needs.

Professional: \$108 (\$96 to renew) + \$10 State dues. Includes all membership privileges, discounts to continuing education events, and subscriptions to the monthly ASCLS newsletter ASCLS Today, the award-winning bi-monthly journal Clinical Laboratory Science, and the ASCLS-Idaho newsletter Focus.

Ascending Professional: \$60 (\$48 to renew) + \$10 State dues - Ascending Professional membership is open to any individual eligible for Professional membership, if the individual has not held previous membership other than Developing Professional or Ascending Professional membership in this Society and is within five years of graduation from a program of clinical laboratory studies.

Developing Professional: \$24. Developing Professional membership shall be open to any person enrolled in a program of clinical laboratory studies.

Emeritus: \$24. Open to any an individual who has been a professional member of ASCLS and **whose age and years of continuous professional membership are equal to or greater than 90**. If you think you qualify, please email ascls@ascls.org.

Community: \$72 to join (\$60 to renew). Community membership shall be open to all persons. Community membership is **NOT eligible** for member discounts for live ASCLS national events and does **NOT count** towards continuous professional membership in the society, which is used for eligibility of emeritus membership status. Community members cannot hold office or vote in ASCLS elections.

General Convention Information

Exhibits

Thursday, April 11

Evening with Vendor.....4:00-6:00 pm

Friday, April 12

Breakfast with the Vendors.....8:00-9:30 am

Lunch with the Vendors.....12:45-2:00 pm

Business Meetings

Saturday, April 13

Business Lunch.....12:00-1:30 pm

Social Functions

Thursday, April 11

Scientific Assembly Lunch.....12:45-2:00 pm

Student Dining & Gathering.....6:00-8:00 pm

Friday, April 12

Friday Morning Stretch Session.....7:00-8:00 am

Friday Night Banquet6:00-8:30 pm

ASCLS-Idaho 2019 Convention Guide

Time	Thursday, April 11
9:30-11:00 am	Opening Presentation G1
11:00-11:15 am	Break
11:45-12:45 pm	General Session G2
12:45-2:00 pm	Scientific Assembly Lunch
2:00-3:30 pm	Break Out Session A-1 Break Out Session A-2
4:00-6:00 pm	Evening Vendor Session
6:00-8:00 pm	Student Dining/Gathering

Time	Friday, April 12
7:00-8:00 am	Stretch Session
8:00-9:30 am	Breakfast w/ Vendors
9:30-11:00 am	Keynote G-3
11:00-11:15 am	Break
11:15-12:45 pm	Break Out Session B1 Break Out Session B2 Break Out Session B3
12:45-2:00 pm	Lunch w/ Vendors
2:00-3:30 pm	Break Out Session B4 Break Out Session B5 Break Out Session B6
3:30-4:00 pm	Break
4:00-5:30 pm	Student Poster Session
5:30-6:00 pm	Student Introduction & Pinning
6:00-8:30 pm	Friday Night Banquet

Time	Saturday, April 13
8:00-9:00 am	Educator's Forum
9:00-10:00 am	General Session G4
10:00-10:30 am	Break
10:30-12:00 pm	General Session G5
12:00-1:30 pm	Business Lunch

Thursday, April 11 Workshops

9:30-11:00 am

General Session G1 - Leadership

Speaker: Nicole Bradshaw

Sponsor: Valor Healthcare

More information to follow – please check website for updates.

11:45-12:45 am

General Session G2 - Professional Resilience: Staying on Board!

Speaker: Kelly Loy, LAMFT, LPC, NCC, CCFT, BCC, RN, MDiv

Sponsor: Shared Path Counseling

Stay on board in your profession! This presentation will share a basic review of neuroscience related to brain physiology and processing of stress. Differences between Burnout, Secondary Traumatic Stress, and Compassion Fatigue will be discussed. The PToQOL assessment tool and multiple additional interventions will be reviewed for building professional resilience.

2:00-3:30 pm

Break Out Session A1 - The Clinical Lab's Role in Antibiotic Stewardship

Speaker: Larry Schuermann, MT(ASCP)

Sponsor: Utah Fertility Center

This lecture will cover Antibiotic Stewardship and how it applies to the field of clinical laboratory science. Included will be general discussion of what is stewardship, CMS and other regulatory regulations, Core elements of stewardship, antibiograms and other reporting tools.

2:00 – 3:30 pm

Break Out Session A2 - Clinical & Economic Value of anti-Xa Monitoring in Patients Receiving Unfractionated Heparin

Speaker: Karen Burns, CLS(ASCP), Coagulation Application Consultant

Sponsor: Instrumentation Laboratories

In this session, we will look at the way Anti-Xa has changed the way we monitor patients on unfractionated heparin therapy (UFH). We will describe the role of heparin and review a study comparing Anti-Xa and aPTT testing for monitoring therapy. We will look at the advantages of Anti-Xa and outline a plan for the transition from aPTT to Anti-Xa monitoring.

Friday, April 12 Workshops

9:30-11:00 am

Keynote Address: G3 - Laboratory Stewardship: and Test Utilization: Still a Golden Opportunity for Improvement

Speaker: Robert Carpenter MS, MT(ASCP)

Sponsor: ARUP Laboratories

This session will address many aspects of Laboratory Stewardship, including why it so important and how to get started or expand existing efforts. Attendees will learn the key factors that are necessary for initial and ongoing success, and several case study success stories will be discussed.

11:15-12:45 am

Break Out Session B1 - Diagnosis and follow-up of Multiple Myeloma and Related Disorders: the Role of the laboratory

Speaker: Anne Sherwood, PhD, and Director of Scientific Affairs

Sponsor: Binding Site

This session will compare traditional myeloma testing methods with current recommended protocols and describe how kappa & lambda free light chain analysis plays a key role. Discuss the updated IMWG criteria for diagnosis of Multiple Myeloma and new recommendations for inclusion in routine practice. It will also explain why it is necessary to monitor both intact immunoglobulin paraprotein and serum free light chains in multiple myeloma.

11:45-12:45 am

Break Out Session B2 – Highly Sensitive Troponins

Speaker: Teresa Joseph, Cardiac Medical Science Liaison

Sponsor: Roche

More information to follow – please check website for updates.

11:15-12:45

Break Out Session B3 - Platelets - Purpose, Pictures plus Problems

Speaker: Evelyn Graham MT(ASCP), Director of Laboratory Services, Cancer Hematology Center

Sponsor: Sysmex America, Inc

This presentation takes an in depth look at the function of platelets, describes their role in the clotting process, and explores conditions triggering platelet activation. In addition, specific disease states involving Platelets will be reviewed and case studies will be presented to demonstrate platelet involvement and associated clinical outcomes.

2:00-3:30

Break Out Session B4 – Deep DNA Sequencing of Human Tumors: Next Generation Pathology

Speaker: Matthew Burtelow, MD, PhD

Sponsor: Boise Pathology Group

From this session, attendees will be able to understand the basics of cancer biology. They will also recognize the basic concepts of next generation DNA sequencing as well as next generation DNA sequencing of human tumors. The lecture will also help attendees to understand the limitations of precision medicine in oncology.

2:00-3:30

Break Out Session B5 – Therapeutic Monoclonal Antibodies & Blood Bank Mitigation Strategies

Speaker: Sherrie Lamitina

Sponsor: American Red Cross

Attendees will gain an understating of the effects certain therapeutic monoclonal antibodies have on pre-transfusion testing. They will learn to recognize potential interference in testing from patient undergoing treatment with monoclonal antibodies. Case studies will illustrate the mitigation strategies involved in obtaining blood products for transfusion therapy.

2:00-3:30

Break Out Session B6 – Life After Graduation

Speaker – Kate DeAngelo MLS(ASCP), Mechelle Reeve MLS(ASCP)

Sponsor: ASCLS-Idaho

This session is geared towards developing and ascending professionals detailing life after graduation. Topics to be discussed include Having Successful Clinical Rotations, Taking the BOC (Board of Certification) Exam, Resources for Finding Jobs in Idaho, Interview Skills, Landing the Job, Maintaining CEs (Continuing Education credits), ASCLS, and Leadership Academy.

Saturday, April 13 Workshops

8:00-9:00 am

Educators' Forum

Speaker: Rachel Hulse

Sponsor: Idaho State University

This session will be an informative session about the progress of the MLS program at Idaho State University. Rachel, the director, will share successes of the program in the past year as well as improvement points that she and the faculty are eager to implement.

9:00-10:00 am

General Session G-4: Common POCT Deficiency Citing's – Come to the Party Prepared

Speaker: Melinda Davis MT(ASCP), Karen Bulow MT, HT(ASCP)

Sponsor: St Lukes Health System, Boise

This will be a review with open discussion about the top five inspection deficiencies seen with Point of Care Testing. We will discuss CAP and JC standards and reasons why these deficiencies commonly occur. The session will be open to discussion on how to address these.

10:30-12:00 am

General Session G-5: Gastrointestinal Microbiome & Health: A Review

Speaker: Nancy Kois, MD, FACP

Sponsor: Veterans Administration Hospital, Boise

Review exponential increase in recent research and publications on the effect gastrointestinal microbiome has on human development, health, and disease.

Speaker Information

Kelly Loy, LAMFT, LPC, NCC, CCFT, BCC, RN, MDiv

Kelly has a lifetime of experience working in healthcare, beginning as a volunteer "candy striper" at her local hospital when she was in junior high and working as a CNA in high school. As an adult, she has worked as a Registered Nurse and Ordained Minister, and for the last twelve years has worked locally as a Board-Certified Chaplain in critical care and outpatient oncology. Kelly is currently a local therapist in private practice, specializing and working with adult survivors of childhood violence and sexual trauma. After her own experiences, Kelly is very excited to share her expertise in supporting healthcare professionals in how to be resilient in their work.

Larry Schuermann MT(ASCP)

Larry has worked in a clinical lab for over 30 years, including 22 years at Valor Health where he was Lab Manager and Infection Control Coordinator. He is currently completing his Master's in Public Health at Idaho State using Antibiotic Stewardship as his thesis topic.

Karen Burns, CLS (ASCP), Coagulation Application Consultant

Karen Burns is a Medical Laboratory Scientist with 30+ years of experience in Laboratory Medicine and is currently the Applications consultant with Instrumentation Laboratory. Karen is passionate about patient care, quality lab results, and supporting all the "unsung" heroes in the clinical laboratory.

Robert Carpenter MS, MT(ASCP)

Rob Carpenter holds a Bachelor of Arts degree in Economics from the University of Illinois, certification as a Medical Technologist (ASCP), and a Master of Science degree in Laboratory Management from Brigham Young University. His 45 years of clinical laboratory experience include Administrative Laboratory Director positions at Children's Hospital Colorado (Aurora CO) and Poudre Valley Hospital (Fort Collins CO), numerous other clinical laboratory leadership, management, and consultative roles, several Malcolm Baldrige National Quality Award criteria teams, and the facilitation of multiple major laboratory construction projects. He currently resides in Chandler AZ and holds a position of Senior Healthcare Consultant at ARUP Laboratories in Salt Lake City UT. He has presented and consulted regionally and nationally on the topics of laboratory stewardship, laboratory networking, outreach testing, leadership, compliance, regulatory issues, and laboratory financial management. His consistent passion is the development and

encouragement of principle-centered leadership and the promotion of value-added and patient-centered service excellence in the clinical laboratory.

Anne L. Sherwood, PhD

Dr. Sherwood received her doctoral degree in molecular biology/virology from Purdue University. She has held positions at Pacific Northwest Research Foundation (Department of Biochemical Oncology) and the Department of Molecular Medicine at Northwest Hospital in Seattle where she investigated expression of tumor markers in various transformed cell lines. She subsequently held the position of Senior Scientist at PriTest Inc. where she was instrumental in the development and optimization of a rapid serological diagnostic assay to screen for *tuberculosis (Mtb or Mbu)* infection in humans, cattle, and European badgers. Dr. Sherwood is an inventor on one issued patent on cloning and expression of a tumor marker associated with lung and liver cancer and on two patents in the area of diagnostic assays for infectious diseases. She is currently Director of Scientific Affairs, Western US for The Binding Site, Inc.

Evelyn Graham MT(ASCP)

Eve Graham is the Director of Laboratory Services for Cancer and Hematology Centers of Western Michigan, the largest oncology center in West Michigan. Eve has been active in promoting excellence in laboratory medicine at the cancer center for over 25 years. As part of her responsibilities, she oversees all aspects of four very busy oncology labs. Eve is dedicated to process improvement to increase patient satisfaction. She serves on the Quality Improvement Committee focusing on best practices. She believes in the cancer centers mission of help, healing and hope for cancer patients and their families.

Matthew Burtelow, MD, PhD

Dr. Burtelow is board certified pathologist for St. Luke's Health System. His areas of expertise include anatomic, clinical, and molecular pathology. He has been with St. Luke's Health System for 10 years and is currently serving for as the Executive Medical Director of the St. Luke's West Region Laboratories. He is also the President of Boise Pathology Group.

Sherrie Lamitina

Sherrie Lamitina serves as the American Red Cross IRL Director for the Lewis and Clark and Arizona Regions. She received a BS from the University of Texas and is a MLS with over 30 years' experience in Immunohematology and Transfusion Medicine both technical and supervisory. Currently Sherrie oversees four Immunohematology Reference labs in four states and works closely with the Medical Director to ensure ARC provides the best available products to meet specific patient needs. Sherrie also served as an affiliate faculty member for the ISU MLS program from 2003-2015.

Kate DeAngelo MLS(ASCP)

Kate was born and raised in Boise. She attended ISU in Pocatello and graduated from the MLS program in 2016. She completed her internship at the Boise VA in the fall of 2016. She currently works at St. Luke's Magic Valley as a graveyard generalist and has been there for 2 years. She enjoys baking and runs half marathons.

Mechelle Reeve MLS(ASCP)

Mechelle is a native of Utah and has always been interested in science from a young age. She obtained her MLS degree at Weber State University and had the opportunity to complete two amazing internships at the Mayo Clinic in Minnesota. She has been an MLS for almost 10 years now and enjoys working in blood bank and hematology, being part of Transfusion Committee at her hospital, and being a preceptor for students and new employees. She is the Past President of ASCLS-Idaho and enjoys the opportunities to learn, network, and serve the Idaho laboratorians through her involvement in ASCLS.

Rachel Hulse

Rachel Hulse has been the Program Director of the Medical Laboratory Sciences Program at Idaho State University for nearly four years now. Rachel graduated from the MLS program at the University of Utah 12 years ago and has worked as a MLS at ARUP, Huntsman Cancer Hospital and Jordan Valley Medical Center while she earned two graduate degrees. Rachel has really enjoyed her role in academics and is excited to work with all of you to continue to improve the program.

Karen Bulow

Karen has several years' experience in the field of point of care testing and education. She has her AACC Point of Care Specialist Certification. Karen feels it is very important for laboratory professionals to support interdisciplinary teamwork and be prepared to support the future state of our profession. She feels she is constantly learning and tries to always be open to mentoring others.

Melinda Davis

Melinda graduated in 1998 from ISU, and worked as a bench tech and preceptor in Blood Bank and Chemistry at the Boise SL Campus. She also worked as a generalist at the Meridian Campus before moving into her role as a Point of Care Coordinator.

She has survived 10 inspections with CAP, JC, CMS and the State of Idaho with affiliated sites during 5 years as a POCC. Melinda believes that continual learning is the key to success, and is a vital part of the evolution of our profession.

Nancy Kois, MD, FCAP

Dr. Kois holds an undergraduate degree from University of California, San Diego in Cell Biology and Biochemistry, a Medical degree from Medical College of Pennsylvania, and obtained her residency training in Anatomic Pathology, Clinical Pathology, and Neuropathology at University of California, San Diego.

Dr. Kois has been a practicing Pathologist in Boise for 18 years, serving the Boise VA, St. Alphonsus, and St. Luke's hospitals. She is also a frequent guest lecturer at ISU and has a faculty appointment at ICOM in Meridian, ID

Hotel Information

**Red Lion Hotel
Boise Downtowner
1800 W. Fairview Avenue
Boise, Idaho 83702
(208) 344-7691**

Room Rates:

\$104 for single-king or \$104 per double/night
Rooms must be booked by March 21st to receive the
discounted rate.

***Be sure to mention ASCLS-Idaho when making your room
reservation.***

The Red Lion Hotel Boise Downtowner is conveniently located near the
core of downtown, off I-184. The hotel is just 10 minutes from the
Centre and many other popular attractions

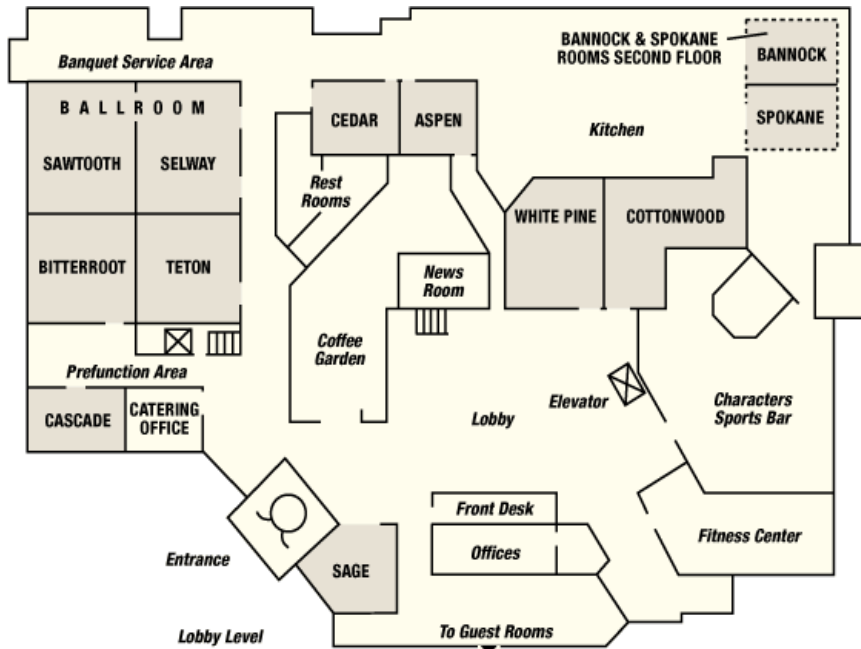

Exhibitors

T2 Biosystems
BioFire Diagnostics
ARUP Laboratories
McKesson
Hettich Instruments
Medical-Chemical Corporation
Audit MicroControls
American Red Cross
bioMerieux, Inc.
Drucker Diagnostics
Roche

*These are the exhibitors as of the date of
printing. Please see website for additional
exhibitors

Sponsors

Pathology Associates
Mountain View Hospital
Idaho State University
ARUP Laboratories
Shared Path Counseling
Instrumentation Laboratories
Sysmex America, Inc
Boise Pathology Group
American Red Cross
ASCLS-Idaho
Veterans Administration Hospital, Boise
West Valley Medical Center
Roche
The Binding Site

*These are the sponsors as of the date of
printing. Please see website for additional
exhibitors

Social Activities:

Thursday Evening Student Social Gathering

All students are invited to a social gathering at the ISU Meridian Campus. There will be food, fun, and an opportunity for all students to meet face to face. The social is being planned by ISU students.

Thursday Evening Downtown Stroll

Join us for a fun time exploring downtown Boise. Enjoy shopping, dining, and walking around this great city.

Friday Morning Stretching

Bring your yoga mat and enjoy some stretching before the convention on Friday morning with Tina.

Friday Awards Banquet

Join ASCLS Idaho for a night of celebration. We will be looking back at laboratory equipment over the years, celebrating our wonderful members, eating yummy food, and having a great time.

Get to Know You Bingo

Want a fun way to network with new laboratory professionals. Play Get to Know You Bingo. There will be opportunities for fun prizes.

See You There!!!!